

ADDRESS: 911 1ST ST

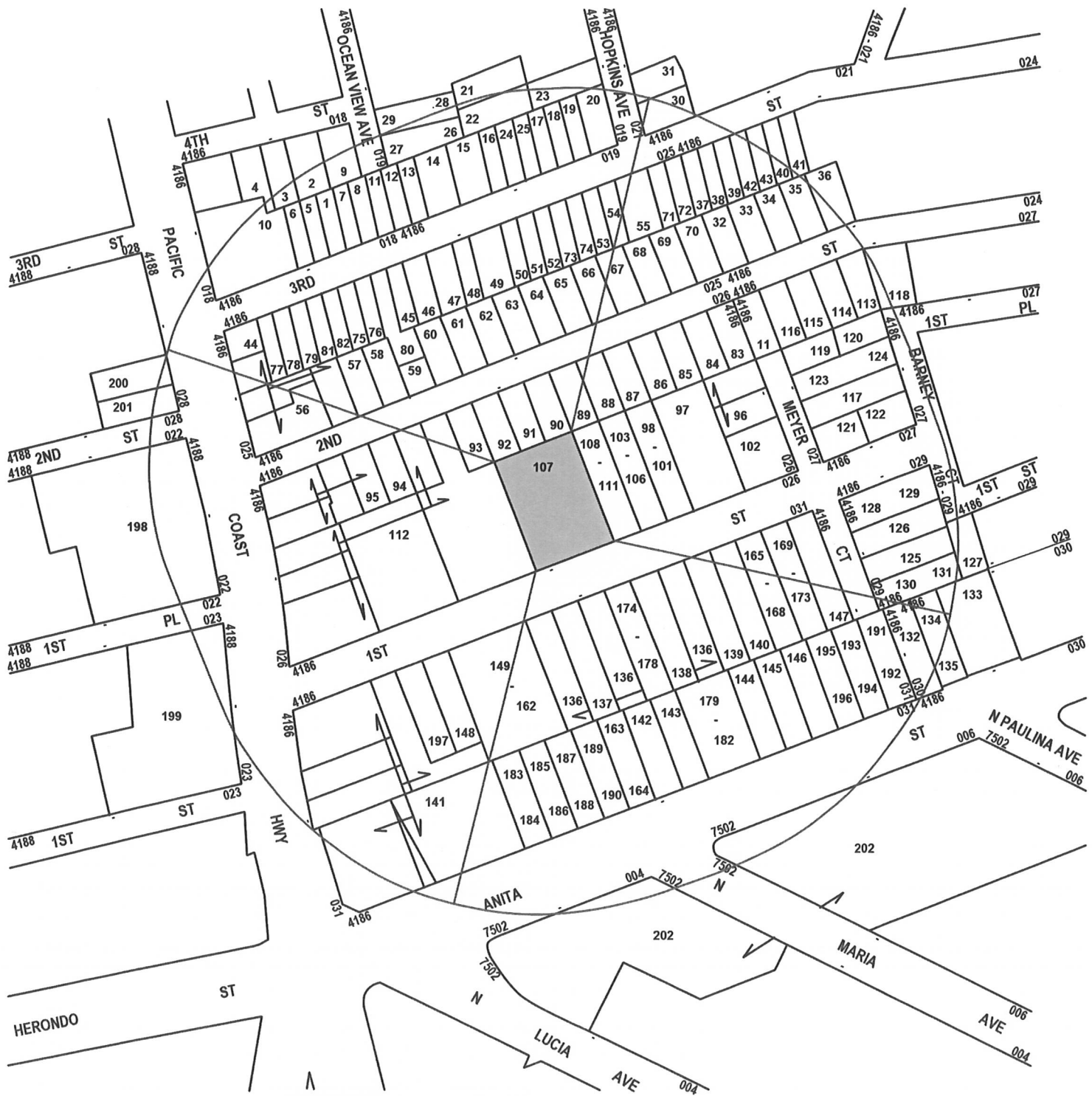

500 FOOT RADIUS MAP		CASE NO.:
 CONTINENTAL MAPPING SERVICE 21220 DEVONSHIRE ST # 205, CHATSWORTH, CA 91311 (818) 787 - 1663		DATE: 10 - 24 - 2022



ADDRESS: 911 1ST ST

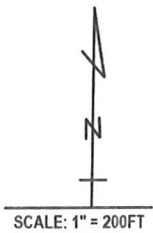

500 FOOT RADIUS MAP		CASE NO.: DATE: 2-24-2022
 CONTINENTAL MAPPING SERVICE 21220 DEVONSHIRE ST # 205, CHATSWORTH, CA 91311 (818) 787 - 1663		

Project Zoning Map

Planning Commission

November 15, 2022



Description

APN: 4186-026-047

911 1st St

Zone: SPA-7 Specific Plan Area 7

Zone and General Plan Amendment, Precise Development Plan, Planned Unit Development for a 12-unit condominium project.

-  R-1 Single Family Residential
-  R-1A Limited Single-Family Residential
-  R-2 Two Family Residential
-  R-2B Limited Multiple Family Residential
-  R-3 Multiple Family Residential
-  R-P Residential-Professional
-  RPD Residential Planned Development
-  R-3PD Multiple Family Planned Development
-  C-1 Limited Business and Residential
-  C-2 General Commercial
-  C-3 General and Highway Commercial
-  M-1 Light Manufacturing
-  OS Open Space
-  OS-1 Restricted Open Space
-  OS-2 Restricted Open Space
-  OS-O Open Space Overlay
-  MHP Mobile Home Park
-  SPA Specific Plan Area (Residential)
-  SPA Specific Plan Area (Commercial)
-  500' Notification Radius

